

## Expansion

- 100,000+ square feet
- \$40M+ public/private partnership
- Positive Proforma
- ADA accessible
- Lobby overflow
- Sports upgrades, lockers, offices, workout rooms, modernized showers . . .
- Premiere 8 sheet curling facility
- Balcony level food/beverage service
- Additional parking (300+)
- Additional entrances
- Display areas
- Technology upgrades
- Community services
- Storage and delivery
- Water mitigation
- Enhanced traffic flow

## St. Croix Valley Recreation Center Expansion Project

Contact  
**ST. CROIX VALLEY**  
*Recreation Center*



1675 Market Dr  
Stillwater, MN  
[recctr@ci.stillwater.mn.us](mailto:recctr@ci.stillwater.mn.us)  
651-592-0031  
(Attention: Doug Brady)



1815 Northwestern Ave #2  
Stillwater, MN

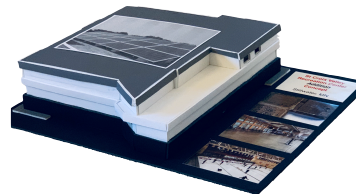



# St. Croix Valley Recreation

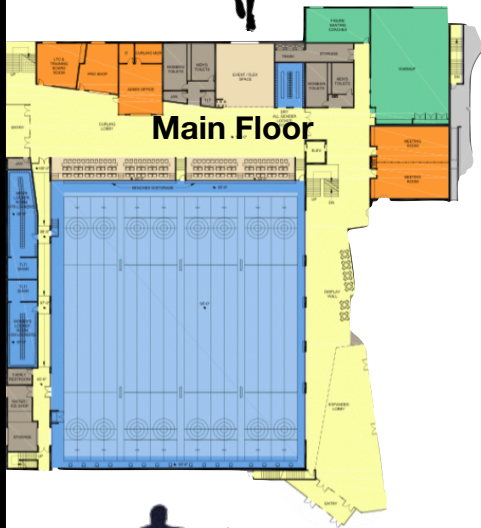

## Center Expansion Project

